

## TUMOR MARKER

**CE** For Professional Use



## One-Step FOB (Fecal Occult Blood) Test

Faecal occult blood (FOB) refers to the small amount of blood in the stool. In healthy people, about 0.5 to 1.5 ml of blood escapes blood vessels into the stool each day. When body disorders happen, such as colorectal cancers, bowel cancer, ulcers, colitis, polyps, and adenomas, the bleeding into intestines will increase significantly. In the early stages, cancers in digestive system often cause slight bleeding into the gut, which are often neglected because there are no symptoms at these stages. But with FOB feces test kit, the occult blood can be detected at low concentration of 40 ng/ml. Since the earlier the diseases like bowel cancer are diagnosed, the better the chance of a cure, an early detection of the FOB in feces is very important to the treatment of many digestive system disorders.

Fecal Occult Blood (FOB) cancer Rapid Test kits are one step immuno-chromatographic testing devices for the qualitative detection of blood hemoglobin in human fecal specimen. FOB rapid tests are intended as an aid in the diagnosis of lower gastrointestinal disorders, such as colorectal cancers and adenomas, intestines, ulcers, colitis, polyps, and bowel cancer.

### Features

1. Sensitivity: 30 ng/ml; Specificity: 99%
2. Take less than 5 minutes to be sure;
3. Detect cancer at early stages, therefore help to reduces severity of related diseases.

### Test Procedure

#### H.Pylori Feaces AG

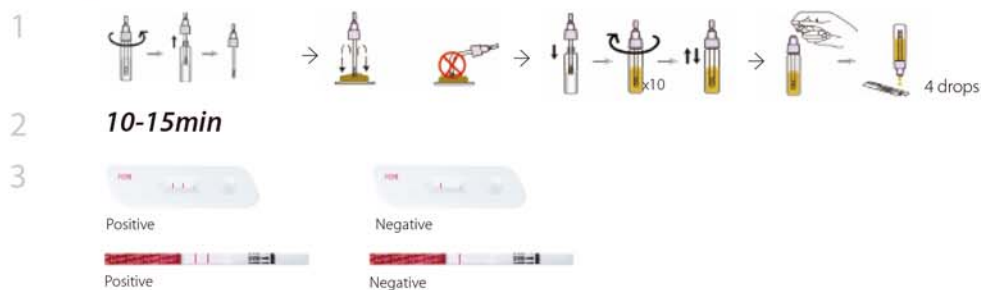

### Ordering information

CAT. NO.	Description	Method	Packing	Specimen	Accessories
FOB 531	FOB Feces Swab Test Strip	GICA	100 Tests/Box; 48 Boxes/Carton	Feces Swab	Feces Collecting Tube
FOB 532	FOB Feces Swab Test Cassette	GICA	25 Tests/Box; 40 Boxes/Carton	Feces Swab	Feces Collecting Tube

\* GICA: Lateral Flow Gold Immunochromatographic Assay;  
 \*\* Carton Outer Size: 52\*45\*36CM. Gross weight about 14-15.5 KG/Carton.